

The Maine Section of the Boston Society of Landscape Architects invites you to a
PRIVATE GARDEN TOUR
of the Coastal Maine Botanical Gardens in Boothbay, Maine

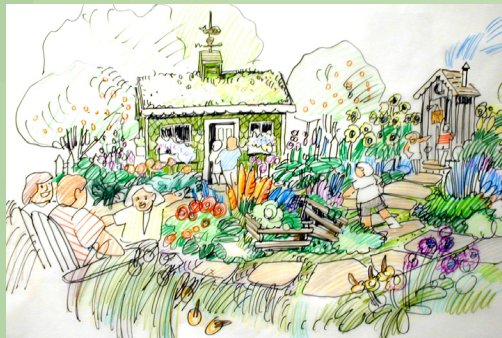

SATURDAY, JUNE 28TH
11AM- 4PM

\$25/PERSON (FEE INCLUDES ENTRANCE & BOX LUNCH)

Schedule of Events (Rain or shine):

- 11am - Noon Introduction and presentation on the development of CMBG by Maureen Heffernan, Executive Director
- Noon - 1pm Presentation by Keith Smith/TJD&A "Implementing EDAW's Master Plan"
- 1pm - 2pm Box lunch
- 2pm - 4pm Tour by Bruce Riddell of Hillside Trail, Meditation & Rhododendron Gardens

RSVP & Non-refundable payment due by June 18th.
Checks only, made payable to "Maine Section BSLA/ASLA."

Send to: MSLA
c/o Terrence J. DeWan & Associates
121 West Main St.
Yarmouth, ME 04096

Event Contact: Amy Segal, segal@tjda.net,
work: 207-846-0757

Please fill out the information below and submit with payment

Printed Name: _____

Number of people in party: _____

Amount enclosed: \$ _____

Email: _____

Phone: _____

CMBG is open from 9am-6pm.
For directions, please visit their web page at: www.mainegardens.org

